

Developing innovative  
technology to improve  
automotive components

The logo for Baolong, featuring a red arc above the word "BAOLONG" in blue, bold, uppercase letters.

**BAOLONG**

PRODUCT CATALOGUE

***AIR RESERVOIR & ALUMINUM PARTS***

# About Baolong Automotive



Year	1997	2017	2025
Factories	5	12	23
R&D Centers	20	15	15
TPMS		50	2500
BUSBAR			

Shanghai Baolong Automotive Corporation was founded in May, 1997 in Songjiang District, Shanghai, and has been listed on Shanghai Stock Exchange since 2017. By the end of 2025, the company has 12 manufacturing campuses, 23 factories, 15 R&D centers, and over 20 sales branches in China (Songjiang District and Pudong District, Shanghai; Ningguo and Hefei, Anhui).

Baolong has become one of the leading global suppliers of tire valves, wheel weights, exhaust pipes, TPMS, and ECAS. It is ranked among China Top 100 Automotive Suppliers and Shanghai Top 50 Manufacturing Enterprises. We've proudly supplied to over 2,500 customers in more than 50 countries. Our main customers include major carmakers, tier-1 suppliers, and independent aftermarket distributors in the world.

Chinese Brands



Foreign Brands

Baolong cooperates with many world-renowned OEMs and Tier 1 suppliers that trust us to implement the most innovative and game-changing

Tier 1 Suppliers



Aftermarket



In alphabetical order of English name



CNAS L12065 Baolong Automotive

ISO 26262 Baolong Automotive



ISO 14001 Ningguo Branch



ISO 45001 Ningguo Branch



IATF 16949 Baolong Automotive



ISO 14001 Anhui Plant



882d-0375D6



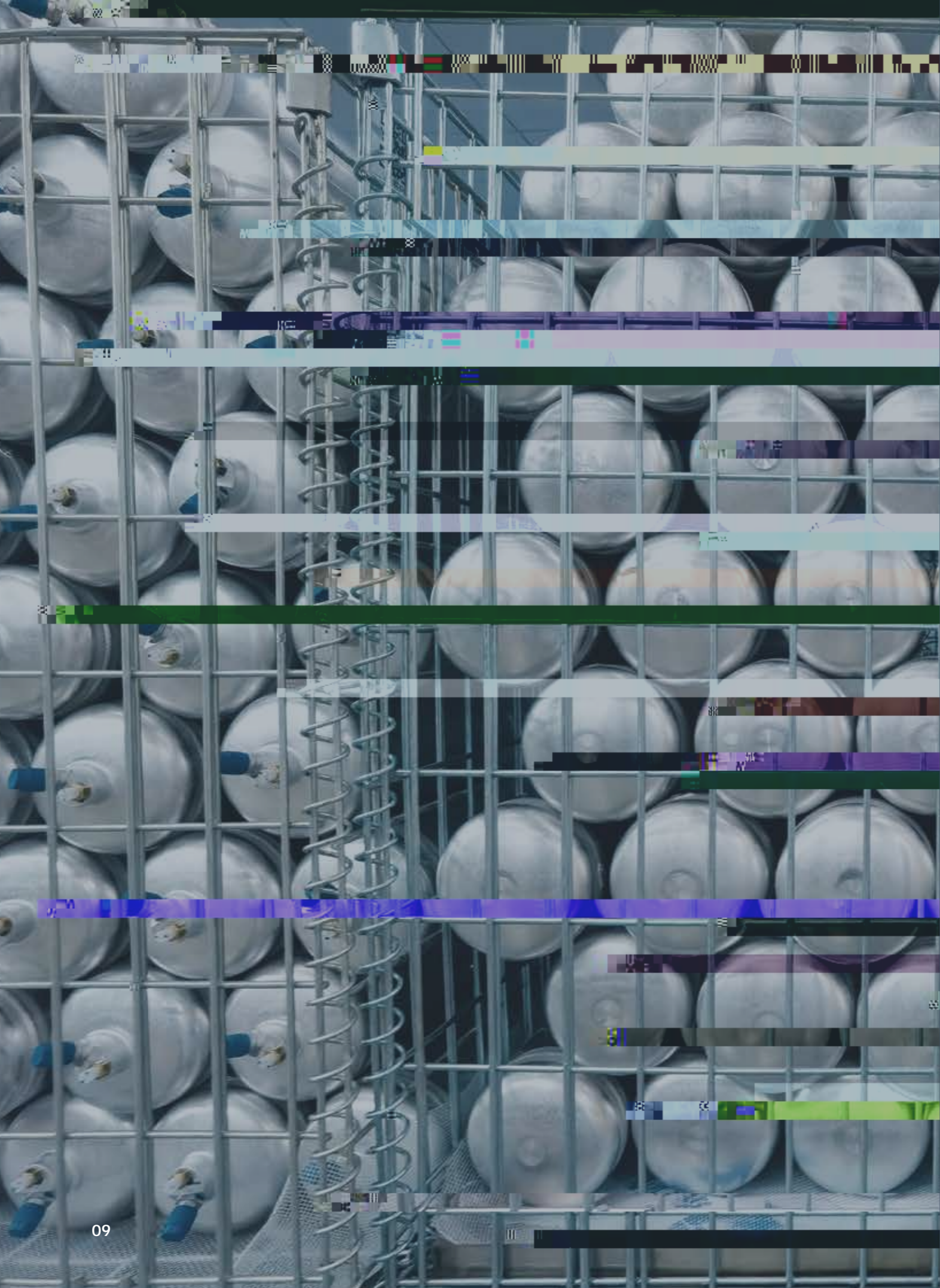

# CONTENTS

11-14

AIR RESERVOIRS

15-20

ALUMINUM PARTS

15

PISTON

16

TOP CAP AIR CHAMBER ALUMINUM FRAME

17

GUIDING TUBE

18

LIQUID STORAGE TANK

19

CONNECTORS & BRACKETS

/Type: AT



/Parameter	
Hoop	
118.2x	118.2x840mm
118.2x	118.2x840mm
8L	
8L	
1.92kg	
1.92kg	
0-20bar	
	0-20bar

/Type: AT



/Parameter	
Bracket	
198x	198x405mm
198x	198x405mm
10L	
10L	
1.8kg	
1.8kg	
0-18bar	
	0-18bar

/Type: AT



/Parameter	
Bracket	
140x	140x770mm
140x	140x770mm
10L	
10L	
2.6kg	
2.6kg	
0-20bar	
	0-20bar

/Type: AT



/Parameter	
Bracket	
170x	170x660mm
170x	170x660mm
13L	
13L	
3.55kg	
3.55kg	
0-18bar	
	0-18bar

/Type: **AT006**



/Parameter
Bracket
123x 123x1140mm 123x 123x 1140mm
12L 12L
2.5kg 2.5kg
0-18bar 0-18bar

/Type: **AT009**

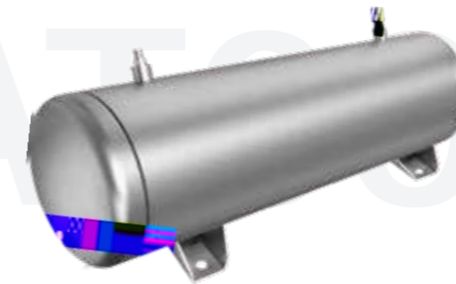

/Parameter
Bracket
150x 150x588mm 150x 150x588mm
9L 9L
2.5kg 2.5kg
0-20bar 0-20bar

/Type: **AT030**



/Parameter
Bracket
162x114.8x950mm 162x114.8x950mm
6L 6L
5.3kg 5.3kg
0-20bar 0-20bar

/Type: **AT013**

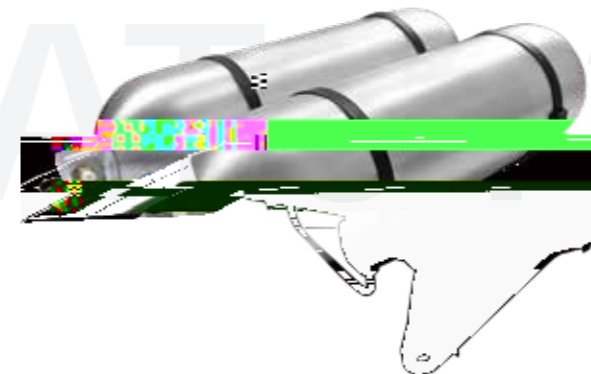

/Parameter
Plastic Tray
260x123x463mm 260x123x463mm
8L 8L
2.5kg 2.5kg
0-18bar 0-18bar

PISTON

/Typ DS

/Parameter

90x 90x227.6mm  
90X 90X227.6mm

6082  
6082



/Typ DS

/Parameter

93.1x 93.1x193mm  
93.1x 93.1x193mm

6082  
6082



/Typ DS

/Parameter

92x 92x192mm  
92x 92x192mm

6082  
6082

TOP CAP

/Typ DS

/Parameter

135x 135x17mm  
135x 135x17mm

6061  
6061



AIR CHAMBER

/Typ DS

/Parameter

135x 135x58mm  
135x 135x58mm

6061  
6061



ALUMINUM FRAME

/Typ DS

/Parameter

141x 141x52.4mm  
141X 141X52.4mm

6063  
6063



/Typ DS

/Parameter

154x 154x120mm  
154x 154x120mm

6063  
6063

/Typ DS



CONNECTORS & BRACKETS

/Typ AS

Parameter

8x24.6x51.6mm  
8x24.6x51.6mm

6061  
6061



/Typ AS

Parameter

22x28x51.6mm  
22x28x51.6mm

3003  
3003

/Typ AS

Parameter

50.8x60.9x71.5mm  
50.8x60.9x71.5mm

6061  
6061



/Typ AS

Parameter

40x24x31.5mm  
40x24x31.5mm

6063  
6063



/Typ SH

Parameter

26x 26x32.5mm  
26x 26x32.5mm

6061  
6061



/Typ AS

Parameter

26x35x88.5mm  
26x35x88.5mm

6005  
6005



